

# Series 5110/G

- Test probe for cable harness testing
- Compact design
- Screwable - threaded design
- Screwing tools available

Mechanical Data	
Center	4.00 mm/160 mil
Full Travel	3.50 mm
Working Travel	2.80 mm
Pre-loaded Spring Force	0.25/ 0.30/ 0.45/ 0.50/ 1.00 N
Spring Force at Working Travel	0.80/ 1.20/ 1.50/ 2.50/ 3.50 N

Electrical Data	
Max. Current Rating	10.0 A
Typical Continuity Resistance	<= 10 mOhm

Materials	
Barrel	Brass, gold plated
Spring	Stainless Steel, gold plated
Plunger	CuBe, gold plated
Receptacle	Brass, gold plated

Recommended Diameter of Drill	
HP 2361.1 (Trolitax)	2.64 mm
HGW 2372	2.65 mm

## Tip style - Diameter - Plating

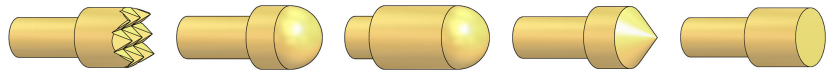

C	D	D1	E	F
2.30C Au 3.50C Au	2.30C Au	2.30C Au	2.30C Au	2.30C Au

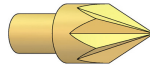

K2
2.30C Au

5110/G

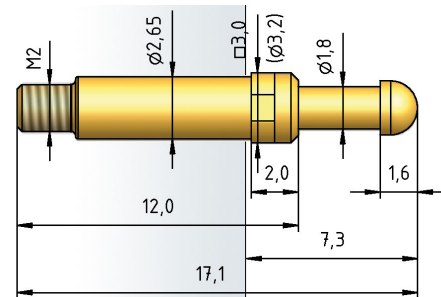

5110/G-K2

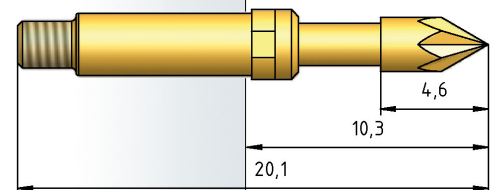

5110/G-D1

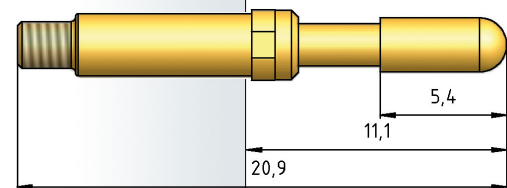

H 5110/GR

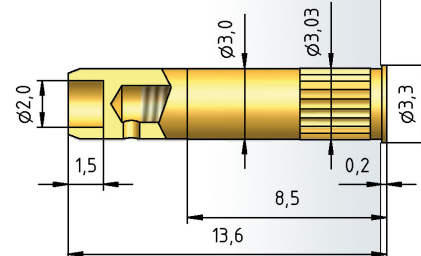

## How to Order

5110/ G - D - 1.5 N - Au - 2.3 C

1 2 3 4 5 6 7

1. Series
2. Threaded Design
3. Tip Style
4. Spring Force
5. Tip Plating
6. Tip Diameter
7. Tip Material (only for CuBe)