

Series 1018.06

- Universal field of application
- Contacting of assembled PCBs

Mechanical Data

Center	2.54 mm/100 mil
Full Travel	4.10 mm
Working Travel	2.70 mm
Pre-loaded Spring Force	0.60 N
Spring Force at Working Travel	1.80 N

Electrical Data

Max. Current Rating	3.0 A
Typical Continuity Resistance	<= 30 mOhm

Materials

Barrel	Bronze, gold plated
Spring	Spring Steel, gold plated
Plunger	Steel
Receptacle	Bronze, gold plated

Recommended Diameter of Drill

HP 2361.1 (Trolitax)	1.67 mm
with pressed-in Ring	1.75 mm
HGW 2372	1.69 mm
with pressed-in Ring	1.76 mm

Tip style - Diameter - Plating

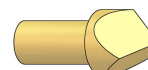
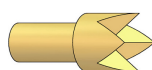

G6	H6
1.54 Au	1.90C Au

1018.06

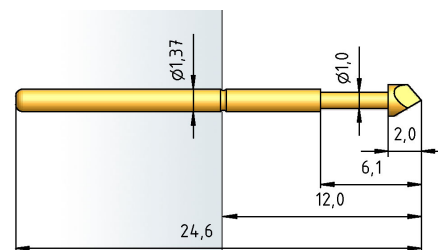

H 1015 C

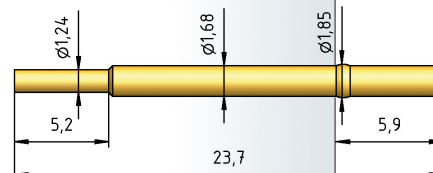

H 1015 L



H 1015 W

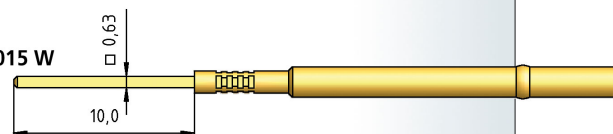

H 1015 C-K

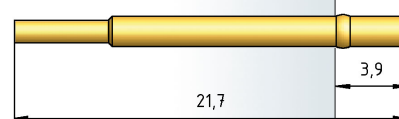

H 1015 L-K



H 1015 W-K

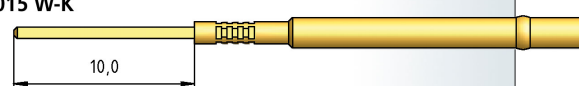

H 1015 WR

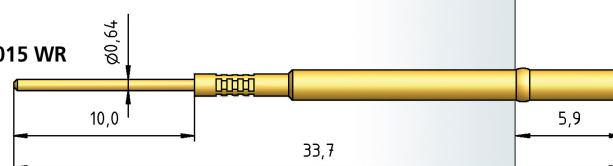

H 1015 WR-K

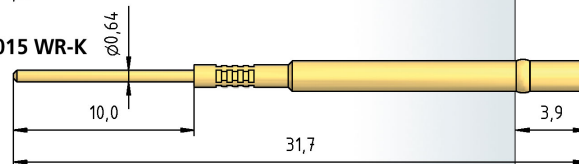

How to Order

1018 .06 - H6 - 1.0 N - Au - 1.9 C

1 2 3 4 5 6 7

1. Series
2. Variant
3. Tip Style
4. Spring Force
5. Tip Plating
6. Tip Diameter
7. Tip Material (only for CuBe)