

Series 1015.50

- Universal field of application
- Contacting of assembled PCBs

Mechanical Data

Center	2.54 mm/100 mil
Full Travel	4.20 mm
Pre-loaded Spring Force	0.35/ 0.50/ 0.70 N
Spring Force at Full Travel	1.00/ 1.50/ 2.50 N

Electrical Data

Max. Current Rating	3.0 A
Typical Continuity Resistance	<= 50 mOhm

Materials

Barrel	Bronze, gold plated
Spring	Stainless Steel, unplated
Plunger	CuBe, rhodium plated
Receptacle	Bronze, gold plated

Recommended Diameter of Drill

HP 2361.1 (Trolitax)	1.66 mm
with pressed-in Ring	1.81 mm
HGW 2372	1.67 mm
with pressed-in Ring	1.82 mm

Tip style - Diameter - Plating

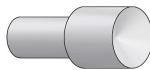

A
1.35C Rh

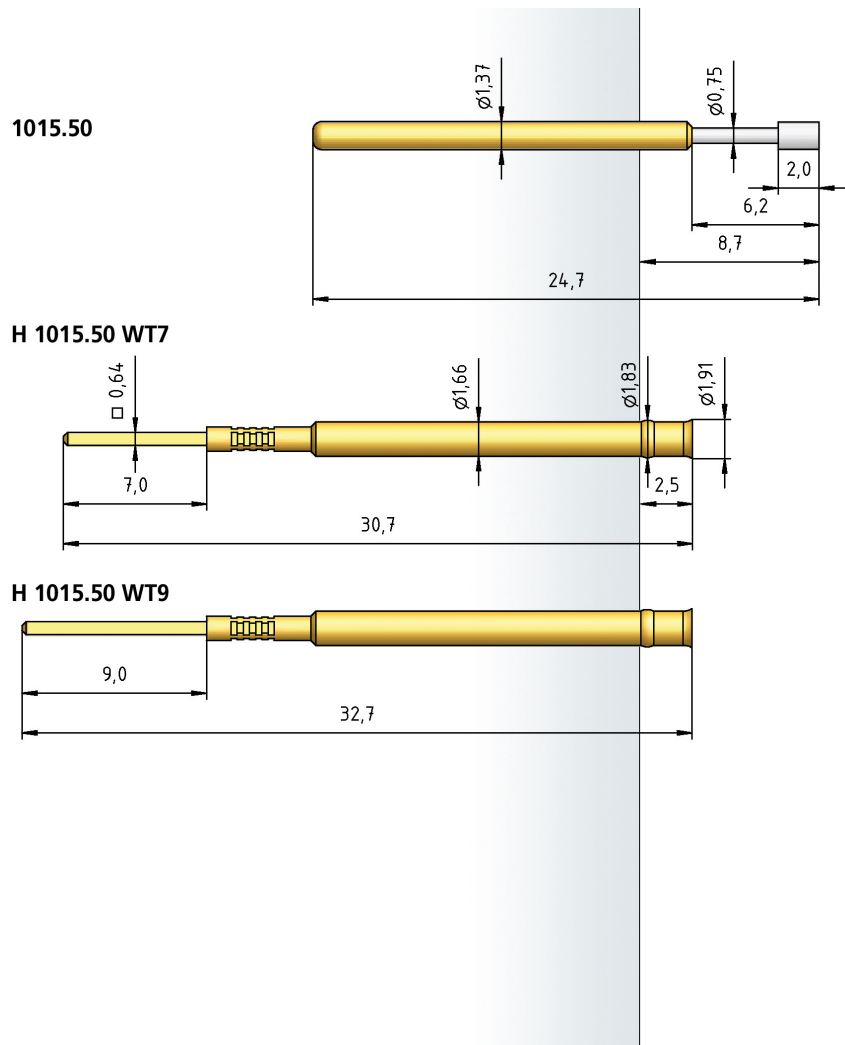

How to Order

1015 .50 - A - 1.5 N - Rh - 1.35 C

1 2 3 4 5 6 7

1. Series
2. Variant
3. Tip Style
4. Spring Force
5. Tip Plating
6. Tip Diameter
7. Tip Material (only for CuBe)